

indirect

LINEAR

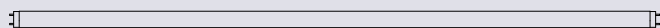

EPITOME PLUS

Epitome Plus utilizing T5 and T5HO lamps gives the illusion that the fixture is 1/2 inch deep making it an excellent choice for low ceiling applications

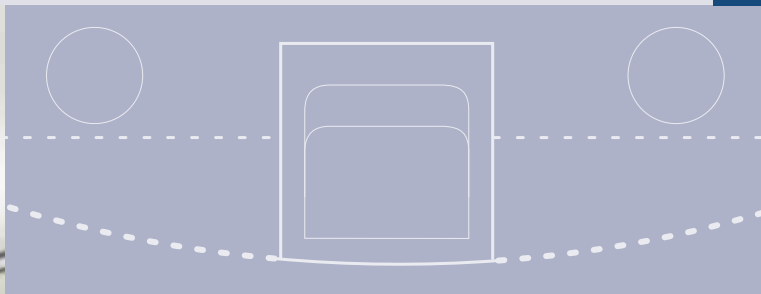
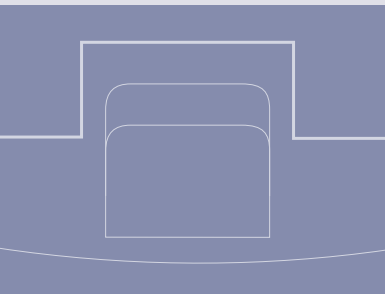

EPITOME PLUS

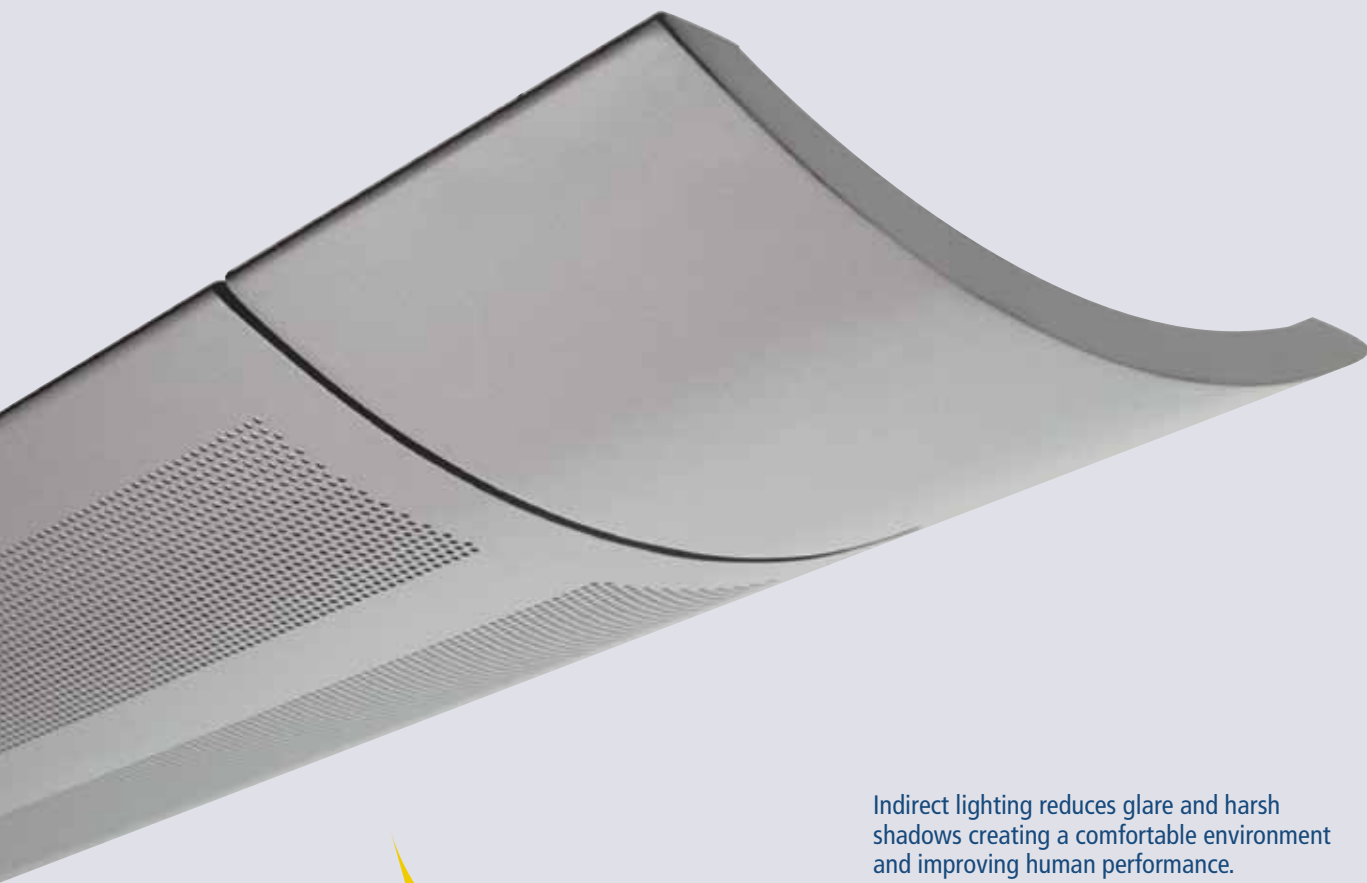

Indirect lighting reduces glare and harsh shadows creating a comfortable environment and improving human performance.



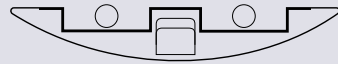

EPP91-2

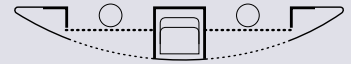

EPP92-2

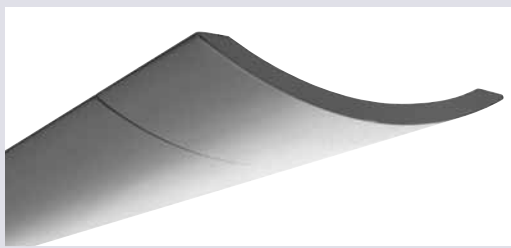

With a shallow depth of 1 1/2 inches and a choice of a smooth or perforated steel housing, Epitome Plus works visually. Its T5 lamp controlled optics allow mountings as close as 12 inches from the ceiling with spacing of 12 feet between rows, maintaining a ceiling uniformity ratio of 7:1 or better.



The perforated bottom allows 7% direct component increasing lighting levels on the work plane and allowing the eye to detect the source without discomfort.

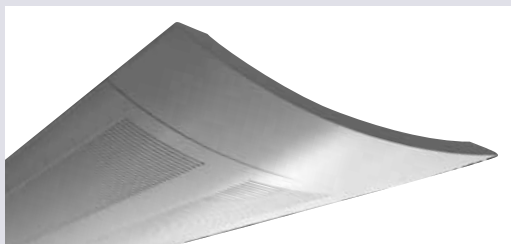

The slotted bottom allows 14% direct component.

SPECIFICATIONS

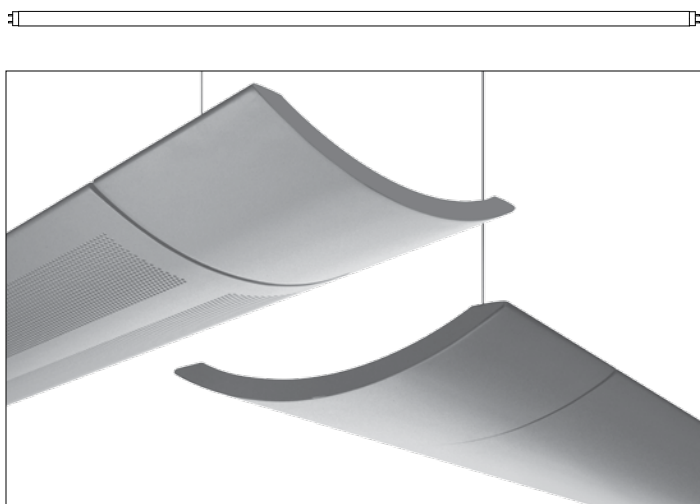

Housing: 18 gauge steel housing in lengths up to 8 feet, with .125" thick end caps. EPP91 is 100% indirect. EPP92 has partially perforated bottom with 7% direct component. EPP93 has a slotted bottom with 14% direct component.

Reflector: Specular aluminum reflector system designed to minimize ceiling brightness above fixture at 12" suspension.

Suspension: Cables are 1/16" stainless steel aircraft cables with end adjustable fitting. 2" mini canopy or 5" canopy (power feed) is provided with a threaded coupler for attachment to a 1/4-20 threaded stud provided by others. Stems are 1/2" outside diameter and are provided with a 30 degree swivel at canopy. Canopies are gloss white standard.

Electrical: Instant start, normal light output, high power factor, sound rated A, >10% THD, 120-Volt to 277-Volt electronic ballast is standard. T5 ballast is 1.05 ballast factor, and T5HO ballast is 1.00 ballast factor for 120-Volt to 277-Volt. Ballast factor for 347-volt ballast (T5HO only) is 1.00.

Finish: Semi-gloss white powder coat paint is standard. Choose from a variety of standard colors on our color chart. Custom colors are available.

Certification: UL and CUL listed. IBEW labeled

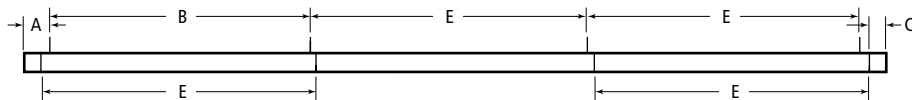
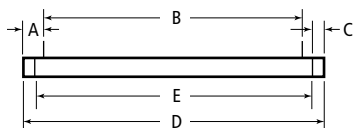

DIMENSIONAL DATA TABLE

	A	B	C	D	E
3'	7 5/8"	31 13/16"	6 1/8"	47 5/16"	34 9/16"
	194	807	156	1197	877
4'	7 5/8"	43 5/8"	6 1/8"	59 3/8"	46 3/8"
	194	1107	156	1502	1177
6'	7 5/8"	66 3/8"	6 1/8"	81 7/8"	69 1/8"
	194	1684	156	2071	1754
8'	7 5/8"	90"	6 1/8"	105 1/2"	92 3/4"
	194	2284	156	2669	2354

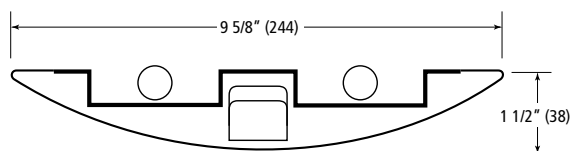

EPP91-2



EPP92-2

EXAMPLE

series	# of lamps	type of lamps	shielding	suspension	length	finish	voltage	options
EPP91	2	T5	O	CB/24"	4	SGW	120	GLR
EPP91 (100% indirect)	2	T5	O-open top	CB/XX"-cable with straight cord	3'	SGW-semi-gloss white	120	GLR-GLR fuse and HLR holder
EPP92 (7% direct)		T5HO		CBC/XX"-cable with white coiled cord	4'	NAP-Natural Aluminum Paint	277	GMF-GMF slow blow fuse and holder
EPP93 (14% direct)				ST/XX"-stem (XX"=specify length from ceiling to top of fixture in inches)	6'	(refer to color chart in Product Selection Guide for other standard colors)	Dual	EM6-LP500 or equal (4' and 8' only)
					8'	CC-custom color	347 (T5HO only)	EM7-LP500 or equal (4' and 8' only)
								EM8-LP600 or equal (4' and 8' only)
								DIM1-Advance Mark VII dimming
								DIM2-Advance Mark X dimming
								DIM3-Lutron ECO-10 dimming ballast
								DIM4-Lutron Hi-Lume dimming ballast

Due to a program of continuous improvement, LAM Lighting reserves the right to make any variation in design or construction to the equipment described.

ORDER

project name: _____ type: _____ quantity: _____

- - - - - - - -

PHOTOMETRICS

EPP91-2-T5

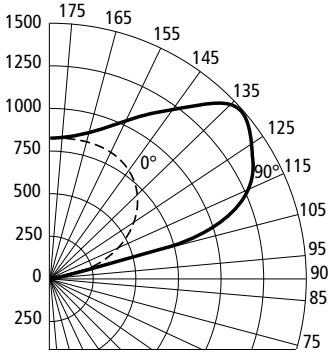

CANDELA DISTRIBUTION

	0	22	45	67	90
180°	843	843	843	843	843
175°	849	849	854	875	854
165°	821	840	875	929	934
155°	752	812	899	1030	1064
145°	657	779	947	1190	1270
135°	520	710	985	1407	1485
125°	406	668	1127	1490	1511
115°	265	671	1048	1197	1223
105°	131	526	651	739	749
95°	30	148	147	124	116
90°	4	5	3	3	3

EPP92-2-T5

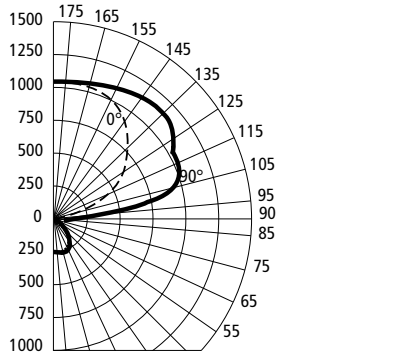

CANDELA DISTRIBUTION

	0	22	45	67	90
180°	999	999	999	999	999
175°	1007	1006	1011	1003	1012
165°	975	980	992	1005	1001
155°	894	906	942	981	998
145°	786	819	899	975	1007
135°	628	681	814	933	979
125°	499	589	792	959	1020
115°	326	471	731	884	966
105°	158	345	589	696	729
95°	30	134	105	87	75
90°	0	10	10	12	13
85°	1	9	12	14	16
75°	13	19	25	28	31
65°	30	52	41	44	46
55°	70	71	81	82	83
45°	89	90	96	102	105
35°	119	119	122	124	127
25°	138	138	138	141	141
15°	156	155	157	157	156
5°	163	162	164	162	163
0°	161	161	161	161	161

ZONAL LUMEN SUMMARY

Zone	Lumens	% Fixture Output	% Lamp Output
0-90°	462	10.3	7.9
90-180°	4016	89.3	68.4
0-180°	4447	100.0	76.6

EPP93-2-T5HO

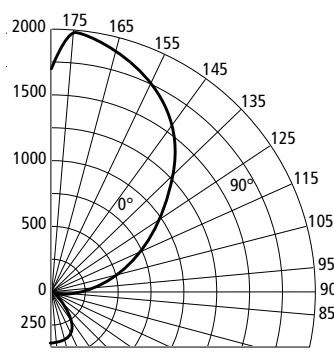

CANDELA DISTRIBUTION

	0	22	45	67	90
180°	1686	1686	1686	1686	1686
175°	1960	1859	1688	1562	1518
165°	1913	1818	1663	1557	1521
155°	1768	1673	1544	1477	1457
145°	1550	1476	1402	1359	1355
135°	1303	1274	1257	1279	1279
125°	1028	1067	1123	1117	1141
115°	732	854	919	1074	1127
105°	428	589	837	883	880
95°	395	329	285	229	205
90°	38	63	59	69	67
85°	36	28	55	71	73
75°	36	51	71	83	85
65°	104	108	112	116	115
55°	177	173	165	160	157
45°	238	228	214	203	199
35°	290	280	260	244	239
25°	330	321	300	283	276
15°	359	350	325	304	296
5°	375	365	340	319	311
0°	344	344	344	344	344

ZONAL LUMEN SUMMARY

Zone	Lumens	% Fixture Output	% Lamp Output
0-90°	990	13.7	9.9
90-180°	6226	86.3	62.3
0-180°	7216	100.0	72.2

ZONAL LUMEN SUMMARY

Zone	Lumens	% Fixture Output	% Lamp Output
0-90°	1	0.0	0.0
90-180°	4752	100.0	81.9
0-180°	4753	100.0	81.9

MOUNTING DETAILS

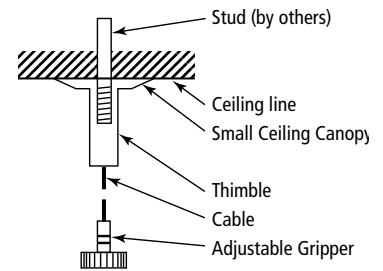
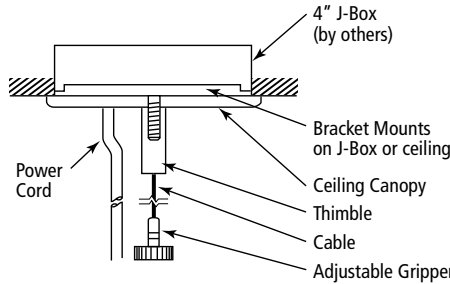
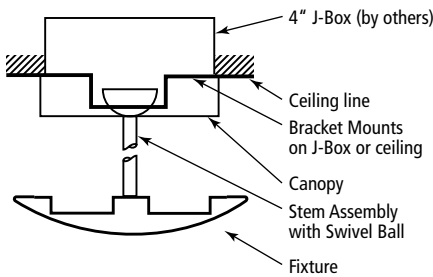

APPLICATION DATA

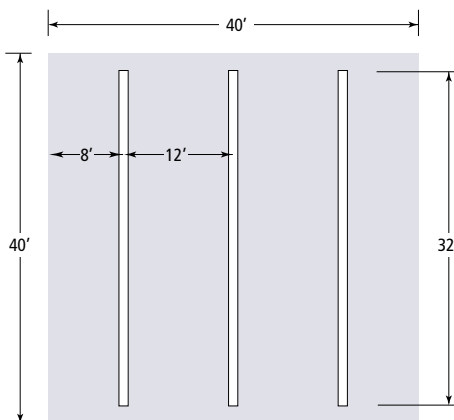

(A) EPP922-T5-O-4, 2 - F28T5, 2900 lumens per lamp, 0.90 LLF, 1.05 Ballast Factor

POWER DENSITY IS 1.0 WATT PER SQUARE FOOT

Suspension (Ceiling to top of fixture)	Footcandle Average at Workplane	Ceiling Uniformity (Max/Min)	Ceiling Luminance (Maximum Cd/ sq. m)
12"	43 FC	7:1	210
18"	44 FC	6:1	250

(B) EPP922-T5-O-4, 2 - F28T5, 2900 lumens per lamp, 0.90 LLF, 1.05 Ballast Factor

POWER DENSITY IS 1.0 WATT PER SQUARE FOOT

Suspension (Ceiling to top of fixture)	Footcandle Average at Workplane	Ceiling Uniformity (Max/Min)	Ceiling Luminance (Maximum Cd/ sq. m)
12"	43 FC	6:1	186

Reflectance: 80/50/20

- (A) Light Loss Factor - 0.95 room depreciation, 0.95 fixture depreciation, 0.95 lamp depreciation, 1.05 ballast factor = 0.90 total LLF
- (B) Light Loss Factor - 0.95 room depreciation, 0.95 fixture depreciation, 0.95 lamp depreciation, 1.05 ballast factor = 0.90 total LLF