

SPECIFICATIONS

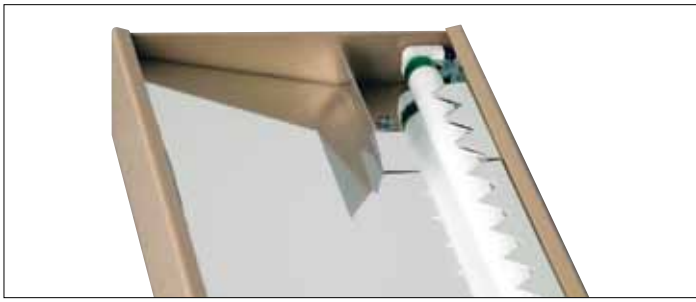

**Housing:** 18-gauge galvanized steel housing and end plates. Optional tilt brackets allow 5°, 10° or 15° fixture tilting.

**Reflector:** Spectral aluminum. Asymmetrical (A), symmetrical (S) or asymmetrical wash (W) distributions are available. Asymmetrical has a saw tooth reflector design and reduces brightness on the wall behind fixture and minimizes socket shadow. Symmetrical distributes light equally in the 0 to 180 degree plane. Asymmetrical wash has no saw tooth reflector and washes the wall with light in addition to an asymmetrical distribution.

**Mounting:** Cove mount (CM) or wall mount (WM). Wall mount fixture will have exposed fasteners.

**Electrical:** Instant start, normal light output, high power factor, sound rated A electronic ballast is standard. T8 ballasts are 0.88 ballast factor for 120 and 277-Volt. Ballast factor for T8, 347-Volt varies, consult factory. Ballast factor for T5 is 1.05 for 120 and 277-Volt and 0.95 for 347-Volt. Ballast factor for T5HO is 1.00.

**Finish:** Galvanized steel finish is standard. Housing can be painted semi-gloss white or choose from a variety of standard colors on our color chart.

**Certification:** UL, CUL, and IBEW union labeled.



LENGTH DIMENSIONS

Nominal length	T8	T5/T5HO
2'	24 7/16" 620	22 1/2" 571
3'	36 7/16" 925	34 1/4" 869
4'	47 7/8" 1229	46 3/16" 1172
5'	60 7/16" 1534	58" 1472
6'	72 3/4" 1846	68 3/8" 1735
8'	96 3/4" 2456	92 5/8" 2353

**Note:** 5' fixture has nominal 5' lamp standard.

WALL MOUNT CROSS SECTION DIMENSIONS

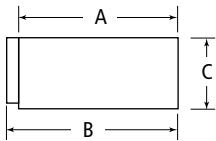

Dimensions

Fixture	A	B	C
SHPD	3 5/8"	4 1/8"	2 1/8"
	92	108	54
HPD	6 5/16"	6 13/16"	2 7/8"
	160	176	73
CHPD	6 5/16"	6 13/16"	2 3/16"
	160	176	56

COVE MOUNT CROSS SECTION DIMENSIONS

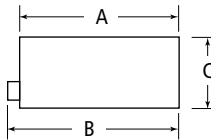

0° Tilt Dimensions

Fixture	A	B	C
SHPD	3 5/8"	4 1/16"	2 1/8"
	92	103	54
HPD	6 5/16"	6 3/4"	2 7/8"
	160	171	73
CHPD	6 5/16"	6 3/4"	2 3/16"
	160	171	56

0° TILT

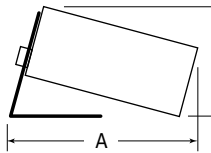

15° Tilt Dimensions

Fixture	A	B
SHPD	4 5/16"	3"
	110	76
HPD	7 5/16"	4 3/8"
	186	111
CHPD	7 1/8"	3 3/4"
	181	95

15° TILT

EXAMPLE

fixture series	distribution	# of lamps	type of lamp	mounting	length	finish	voltage	options
<b>HPD</b>	<b>A</b>	<b>2</b>	<b>T5</b>	<b>CM</b>	<b>4</b>	<b>GLV</b>	<b>120</b>	<b>GLR</b>

- SHPD**      **A**-asymmetrical      **1**      **T5**      **CM**-cove mount
- HPD**      **S**-symmetrical      **2** (HPD only)      **T5HO**      **WM**-wall mount
- CHPD**      **W**-wash asymmetrical
- 2'**      **GLV**-galvanized      **120**      **GLR**-GLR fuse and HLR holder
- 3'**      **SGW**-semi-gloss white      **277**      **GMF**-GMF slow blow fuse and holder
- 4'**      (refer to color chart in the Product Selection Guide for other standard colors)      **Dual**      **EM1**-B70A or equal
- 5'**      **CC**-custom color      **347**      **EM2**-B50 or equal
- 6'**                     **EM3**-B100 or equal
- 8'**                     **EM4**-B60 or equal
- DIM1**-Advance Mark VII dimming
- DIM2**-Advance Mark X dimming
- DIM3**-Lutron ECO-10 dimming ballast
- DIM4**-Lutron Hi-Lume dimming ballast (T5HO only)
- DIM5**-Lutron ECO-10 TVE dimming ballast
- DIM6**-Lutron Tu-Wire dimming ballast (T8 only)
- T5**-5° tilt bracket
- T10**-10° tilt bracket
- T15**-15° tilt bracket
- DC**-dust cover

Due to a program of continuous improvement, LAM Lighting reserves the right to make any variation in design or construction to the equipment described.

ORDER

project name: \_\_\_\_\_ type: \_\_\_\_\_ quantity: \_\_\_\_\_

-  -  -  -  -  -  -  -  -